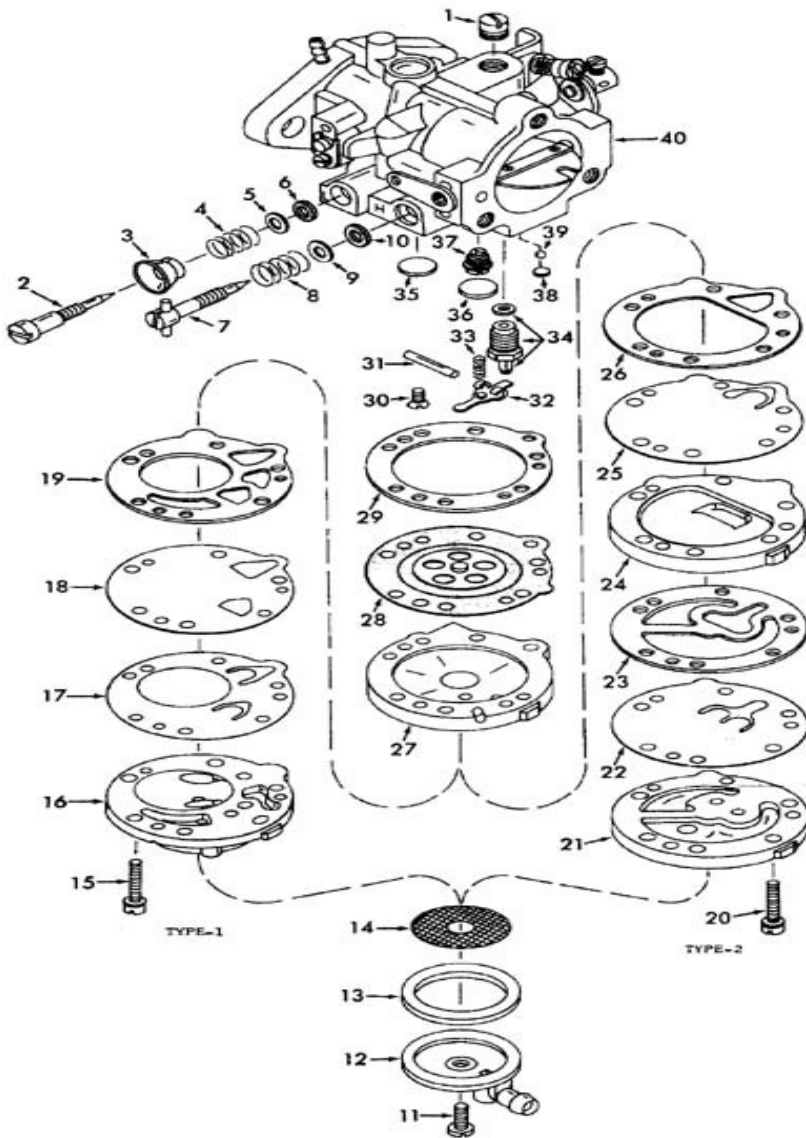

INSTRUCTION SHEET Page 1
TILLOTSON™ CARBURETOR - MODEL HR
GENERAL EXPLODED VIEW

THE GENERAL DESIGN AND PARTS SHOWN WILL VARY TO
INDIVIDUAL UNITS COVERED ON THIS INSTRUCTION SHEET

**NOMENCLATURE****REF. NO.**

1. PLUG SCREW - BODY CHANNEL
2. NEEDLE - IDLE ADJUSTING
3. CUP - IDLE ADJUSTING NEEDLE
4. SPRING - IDLE ADJUSTING NEEDLE
5. WASHER - IDLE NEEDLE SPRING
6. O-RING - IDLE NEEDLE
7. NEEDLE - HIGH SPEED ADJUSTING
8. SPRING - HIGH SPEED ADJUSTING NEEDLE
9. WASHER - HIGH SPEED NEEDLE SPRING
10. O-RING HIGH SPEED NEEDLE
11. SCREW - FUEL STRAINER COVER
12. COVER - FUEL STRAINER
13. GASKET - FUEL STRAINER
14. SCREEN - FUEL STRAINER
- TYPE 1 -
15. SCREW & LOCKWASHER
(6) FUEL PUMP BODY
16. BODY - FUEL PUMP
17. DIAPHRAGM (VALVE) - FUEL PUMP
18. DIAPHRAGM (PULSE) - FUEL PUMP
19. GASKET - FUEL PUMP
- TYPE 2 -
20. SCREW & LOCKWASHER (6)
- INLET VALVE BODY
21. BODY - INLET VALVE
22. DIAPHRAGM - INLET VALVE
23. GASKET - INLET VALVE
24. BODY - FUEL PUMP
25. DIAPHRAGM - FUEL PUMP
26. GASKET - FUEL PUMP
27. COVER - DIAPHRAGM
28. DIAPHRAGM
29. GASKET - DIAPHRAGM
30. SCREW - LEVER FULCRUM PIN RETAINER
31. PIN - LEVER FULCRUM
32. LEVER - INLET CONTROL
33. SPRING - INLET LEVER TENSION
34. NEEDLE, SEAT & GASKET ASSEMBLY
35. WELCH PLUG - IDLE PORT
36. WELCH PLUG - NOZZLE
CHECK VALVE
37. VALVE - NOZZLE CHECK
38. WELCH PLUG -
ECONOMIZER CHECK BALL
(SOME MODELS)
39. BALL - ECONOMIZER CHECK
(SOME MODELS)
40. BODY - MAIN CARBURETOR

DISASSEMBLY

USE EXPLODED VIEW AS A GUIDE. THE NUMERICAL SEQUENCE
MAY GENERALLY BE FOLLOWED TO DISASSEMBLE UNIT FAR
ENOUGH TO PERMIT CLEANING AND INSPECTION.

NOTE: IF WELCH PLUGS ARE REMOVED, CAREFULLY DRILL
THROUGH THICKNESS OF PLUG,
USING A 1/8" DRILL. THEN PRY OUT WELCH PLUG, USING A
SMALL PUNCH.