

INSTRUCTION SHEET Page 1
TILLOTSON[™] CARBURETOR - MODEL HD
GENERAL EXPLODED VIEW
THE GENERAL DESIGN AND PARTS SHOWN WILL VARY TO
INDIVIDUAL UNITS COVERED ON THIS INSTRUCTION SHEET

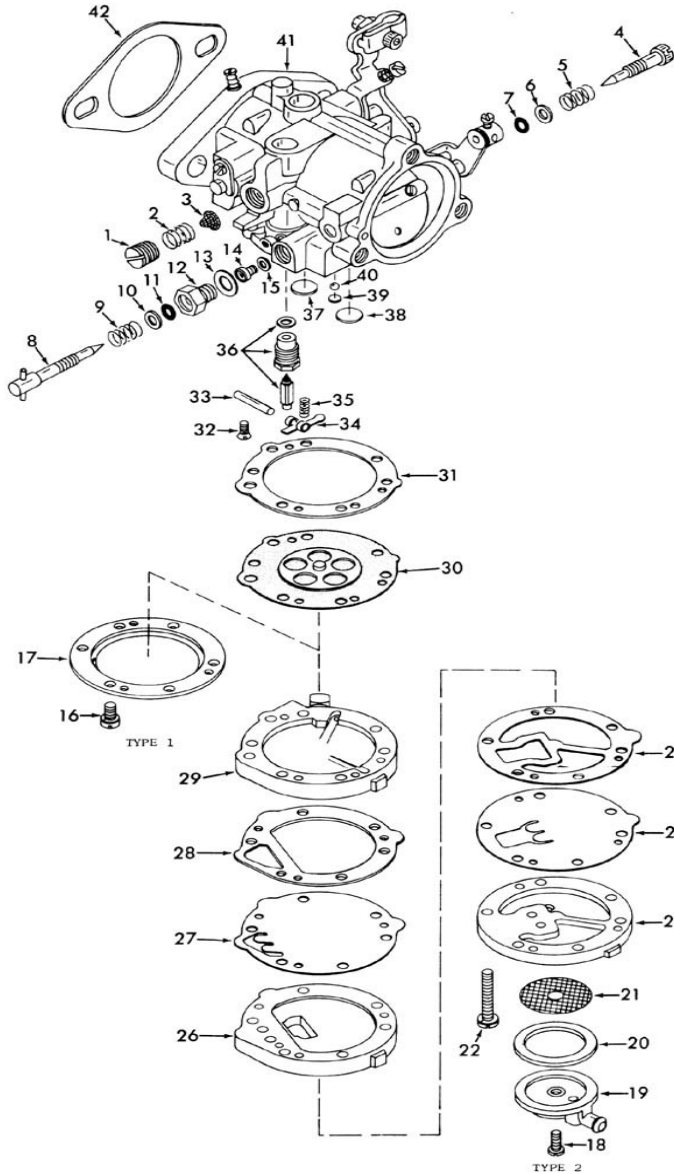

NOMENCLATURE
REF. NO.

1. PLUG SCREW - BODY CHANNEL
2. SPRING - INLET SCREEN RETAINER
3. SCREEN - INLET
4. NEEDLE - IDLE ADJUSTING
5. SPRING - IDLE ADJUSTING NEEDLE
6. WASHER - IDLE NEEDLE SPRING
7. O-RING - IDLE NEEDLE
8. NEEDLE - HIGH SPEED ADJUSTING
9. SPRING - HIGH SPEED ADJUSTING NEEDLE
10. WASHER - HIGH SPEED NEEDLE SPRING
11. O-RING HIGH SPEED NEEDLE
12. GLAND - HIGH SPEED NEEDLE
13. GASKET - GLAND
14. JET - MAIN
15. GASKET - MAIN JET
- TYPE 1 -
16. SCREW & LOCKWASHER (6) DIAPHRAGM COVER
17. COVER - DIAPHRAGM
- TYPE 2 -
18. SCREW - FUEL STRAINER COVER
19. COVER - FUEL STRAINER
20. GASKET - FUEL STRAINER COVER
21. SCREEN - FUEL STRAINER
22. SCREW & LOCKWASHER (6) - INLET VALVE BODY
23. BODY - INLET VALVE
24. DIAPHRAGM - INLET VALVE
25. GASKET - INLET VALVE
26. BODY - FUEL PUMP
27. DIAPHRAGM - FUEL PUMP
28. GASKET - FUEL PUMP
29. COVER - DIAPHRAGM
30. DIAPHRAGM
31. GASKET - DIAPHRAGM
32. SCREW - LEVER PIN RETAINING
33. PIN - LEVER
34. LEVER - INLET CONTROL
35. SPRING - INLET LEVER TENSION
36. NEEDLE, SEAT & GASKET ASSEMBLY
37. WELCH PLUG - IDLE PORT
38. WELCH PLUG - NOZZLE CHECK VALVE
39. WELCH PLUG - ECONOMIZER CHECK BALL (SOME MODELS)
40. BALL - ECONOMIZER CHECK (SOME MODELS)
41. BODY - MAIN CARBURETOR
42. GASKET - FLANGE

DISASSEMBLY

USE EXPLODED VIEW AS A GUIDE. THE NUMERICAL SEQUENCE MAY GENERALLY BE FOLLOWED TO DISASSEMBLE UNIT FAR ENOUGH TO PERMIT CLEANING AND INSPECTION. NOTE: SOME MODELS HAVE AN EXTERNAL FUEL PUMP WHICH IS REMOVED AS AN ASSEMBLY.

EARLY MODELS HAVE A MAIN JET (14) WITH RIGHT HAND THREADS. LATER MODELS HAVE LEFT HAND THREADS.

IF WELCH PLUGS ARE REMOVED, CAREFULLY DRILL THROUGH THICKNESS OF PLUG, USING A 1/8" DRILL. THEN PRY OUT WELCH PLUG, USING A SMALL PUNCH.